

7 Series Ex db op is LED Luminaire

HILCLARE

LIGHTING MANUFACTURER

— LED BY DESIGN —

Zones: **1** **2** **21** **22** Cat: **2**

High efficiency Zone 1 and Zone 21 LED Luminaire in both standard and emergency formats for use in hazardous areas. A range of sizes from 1-5ft with light output up to 6,675 Lumens.

Low maintenance, High output LED light source and energy efficient control with motion sensor options for controlling single and multiple fittings. Manufactured from impact resistant polycarbonate and high specification marine grade aluminium, the fitting is supplied anodised and painted.

- ✓ Low maintenance high efficiency LED light source
- ✓ Energy efficient control
- ✓ 1', 2', 4' and 5' versions
- ✓ Robust long life Zone 1 enclosure
- ✓ Motion sensor option
- ✓ Standard and emergency variants



Specifications & Options



Label Marking	II 2 GD Ex db op is II* Gb T6 Ex tb op is IIIC T85°C Db (II* - IIC Sizes 1, 2, 4, IIB size 5)	Certification standards	EN/IEC 60079 - 0, -1, -28, -31
Zoned areas	Zones 1, 2, 21 & 22	Certificate No.s	CML 14ATEX 1028X IECEX CML140012X
Ambient range (max)	-20°C to +55°C	IP rating	IP66
Material	Marine grade aluminium body with high impact polycarbonate tube		
Cable entries	4 x M20 iso (3 plugged) as standard other threads available		
Electrical connections	3 wire and earth cable size 4mm ² max. Through wiring versions available		
Light source	High efficiency LED		
Light output	Various ranging from 1,335lm - 6,675lm		
Supply voltage (s)	230V 50/60Hz. Call for details of versions available		
Installation / Mounting	2 x M8 tapped holes. Size 1 335mm, size 2 632mm, size 4 1,242mm, size 5 1,542mm		
Control gear	Electronic Driver		
Dimensions	Size 1 448mm x 158mm, size 2 752mm x 158mm, size 4 1,362mm x 158mm, size 5 1,662mm x 158mm		
Weight	Size 1' 3Kg, size 2' 5Kg, size 4' 7Kg, size 5' 8Kg		

We offer a lighting design service

7 Series Ex db op is LED Luminaire

Spares and accessories available
Refer to main catalogue

CIRCUIT BREAKER / INRUSH CURRENT

Model	typ.Ipeak	No. of Luminaires per single pole Circuit Breaker				
		Type	10A	16A	20A	25A
S726604K	16.2A/184 μ	B	17	27	34	43
		C	28	45	57	71
S753124K	32.4A/184 μ	B	8	13	17	21
		C	14	22	28	35
S766154K	32.4A/184 μ	B	8	13	17	21
		C	14	22	28	35

Supply voltage @230 VAC, mains impedance = 1Ω
In case of multi-pole CB the maximum number is reduced by 20%.
The maximum number may differ depending on CB manufacturer. Please consult the manufacturer specifications.
Circuit Breakers with C characteristics are recommended for LED lighting circuits.

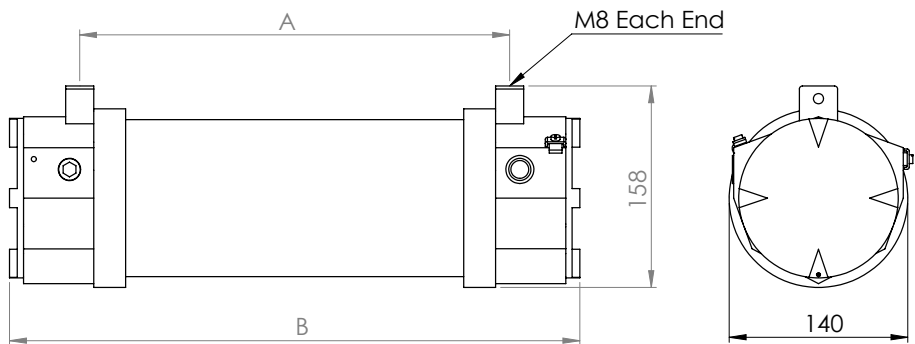

Size	A / mm	B / mm
1	335	448
2	632	752
4	1242	1362
5	1542	1662

ORDERING INFORMATION

	Part Number	Description	Light Source	Light Output	Power Consumption	Size
Standard	S713304K	Zone 1 1300 Tubular Luminaire	LED	1,335lm	15W	448mm
	S726604K	Zone 1 2600 Tubular Luminaire	LED	2,670lm	30W	752mm
	S753124K	Zone 1 5300 Tubular Luminaire	LED	5,340lm	55W	1,362mm
	S766154K	Zone 1 6600 Tubular Luminaire	LED	6,675lm	70W	1,662mm

	Part Number	Description	Light Source	Light Output	Power Consumption	Size
Emergency	S713304KEM	Zone 1 1300 Emergency Luminaire	LED	1,335lm	15W	448mm
	S726604KEM	Zone 1 2600 Emergency Luminaire	LED	2,670lm	30W	752mm
	S753124KEM	Zone 1 5300 Emergency Luminaire	LED	5,340lm	55W	1,362mm
	S766154KEM	Zone 1 6600 Emergency Luminaire	LED	6,675lm	70W	1,662mm

For safer hazardous areas call us today on

0161 274 0165

sales@hilclare.com | www.hilclare.com

HILCLARE
LIGHTING MANUFACTURER
— LED BY DESIGN —