

# Hachero 2

Surface Mounted, Bulkhead, Tampered-proof



A range of surface mounted anti-vandal decorative luminaires. Constructed from a spun aluminium circular base, with opal polycarbonate diffuser secured by three threaded nuts to threaded studs in base. Suitable for use in corridors, reception areas, hospitals, schools and other internal areas.

Integral, self-test and central battery emergency versions available

Semi-recessing kit available

Microwave presence detection options available

Night light facility option

50,000 hours life

## HILCLARE

LIGHTING MANUFACTURER

— LED BY DESIGN —

a  pilot group company

T: 0161 274 3626  
F: 0161 274 3731  
E: [sales@hilclare.com](mailto:sales@hilclare.com)

15 Carnarvon Street  
Manchester  
M3 1HJ

## Ordering Information

	Code	Weight (kg)	Total Watts	Total Lumens	Luminaire Efficacy	IP Rating	Life	Warranty
9W	S2H094T340	2.55	9	882	92	IP20	50,000hr	5 year
13W	S2H134T340	2.55	13	1280	94	IP20	50,000hr	5 year
14W	S2H144T340	2.55	14	1205	86	IP20	50,000hr	5 year
17W	S2H174T340	2.55	17	1678	93	IP20	50,000hr	5 year
19W	S2H194T340	2.55	19	1778	90	IP20	50,000hr	5 year
27W	S2H274T340	2.55	27	2389	85	IP20	50,000hr	5 year

## Code Builder

Emergency – Add EM  
 Microwave – Add MS9  
 Microwave corridor version – Add MS9MD  
 Colour 3000K – Add 30  
 Dali dimming – Add DA  
 Self-test emergency – Add STEM  
 Night light – Add NL  
 Semi-recessing kit available

## Dimensions

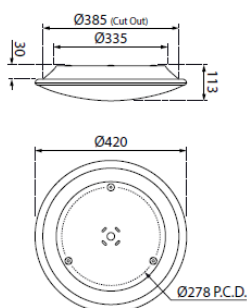

## Photometrics

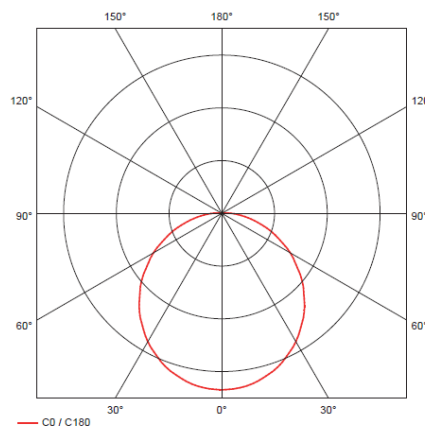

## Classification of Protection

Against electric shock Class 1 protected with earthed metalwork. Against ingress of dust and moisture IP20 Technical Specification.

## Standards

The Hachero 2 range of luminaires is designed and manufactured to meet the requirements of BSEN 60598 2-1.

## Operations

Designed for operation in an interior environment. Ambient temperature range: 0°C to +25°C.  
 230V 50Hz nominal input voltage.

## Specification

A range of surface mounted anti-vandal decorative luminaires. Constructed from a spun aluminium circular base, with opal polycarbonate diffuser secured by three threaded nuts to threaded studs in base. Suitable for use in corridors, reception areas, hospitals, schools and other internal areas.